

WinkPin Instruction manual



Waldhornstrasse 12
D-88662 Überlingen
Fon: +49 (0) 7551.4444
Fax: +49 (0) 7551.918888
www.winkler-technik.com

Preliminary note

- WinkPin for fixing Holding Pins in all Winkler Technik rails and for fixing tubes directly onto insulation boards
- Please use only manual Winkler Technik Holding Pins WPN40, WPN50 und WPN60.

Do not use our normal Holding Pins 2040, 2050 and 2060.

These manual holding pins can be identified by the round disc at the top of the pin. These will not v

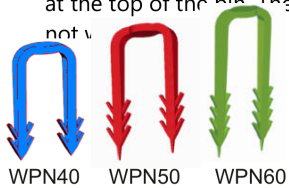

1. Attaching of the foot

- For to packing reasons the foot cannot be pre attached
- Please attach the foot before the first use of the tool into the provided attachment and close the black clamp until it is engaged

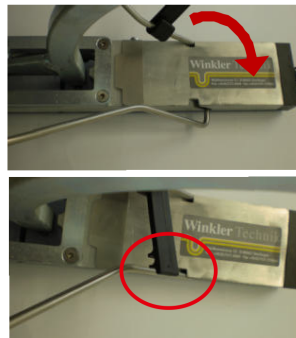

2. Loading of the WinkPin

- The tape holding a magazine of pins together must be removed before using the Winkpin. Bend the lowest pin of the magazine to the back before loading it on to the magazine rod. As soon as you have loaded the tool you can pull the last pin with the tape upwards

- After loading you can let the weight glide out of the weight safety retainer. Make sure that always enough pins will be on the magazine load and that the weight is in the weight safety retainer during loading.



3. Controlling of the adapter

- Please always use the correct adapter for the rail.

| adapter | railtype |
|-------------|------------------|
| WKPA ZS1617 | ZS1617T |
| WKPA ZS20 | ZS20T |
| WKPA 4016T | 4016T |
| WKPA 4017T | 4017T |
| WKPA 4018T | 4018T |
| WKPA 5016 | 5016T |
| WKPA 5017 | 5017T |
| WKPA 5020 | 5020T |
| WKPA 51617 | 51617T25 |
| WKPA OSPS | OS1222 u. PS1217 |
| WKPA JR1417 | JetRail 1417 |

- Make sure that the tube cut-out is at the front side, as shown below



WinkPin Instruction manual



Waldhornstrasse 12
D-88662 Überlingen
Fon: +49 (0) 7551.4444
Fax: +49 (0) 7551.91888
www.winkler-technik.com

4. Changing the adapter

- Depending on the specific mounting rail being used, a different adapter needs to be fitted
- Once the correct adapter has been selected, (see table overleaf) it should be fitted as shown with the tube cut-out at the front.

If the adapter is fixed too strong on the tool, please loose the screw nut (Pos. A). Then turn in / out the inner screw and fasten the screw nut.

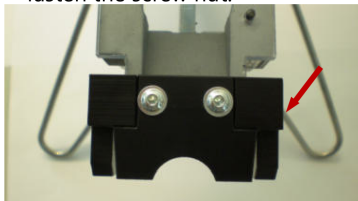

5. Jamming of pins

If a pin has jammed:

- remove the adapter
- lift the perspex plate
- remove the jammed pins
- close it again and re-fit the adapter

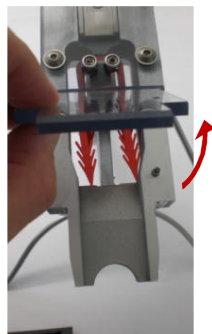

6. Using of the WinkPin

- While working with the WinkPin please hold on to the handle with both hands
- Stand facing the front of the tool and bend the handle towards your body
- The handle should be operated quickly once and with sufficient force to ensure that the tool travels fully to the top of the clip rail or pipe
- Pushing slowly or with insufficient force can cause the pin to remain inside the tool. If this occurs, please do not push again as this can cause jamming: remove the pin and then re-start - see 5.

The WinkPin can only be used with an Adapter, even when

